

# ATRT

## ALUMINUM TAPERED POLE ROUND

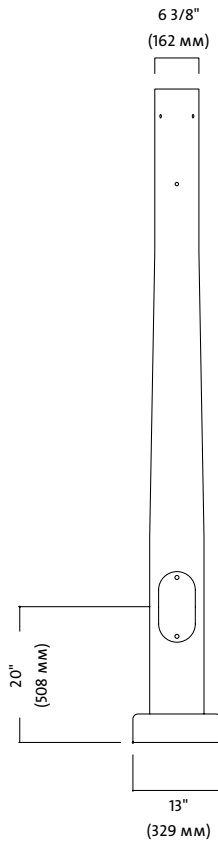

**BASE DETAILS:**

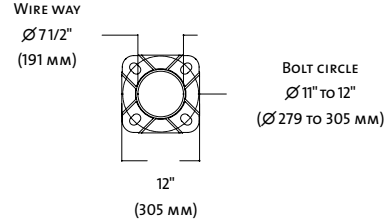
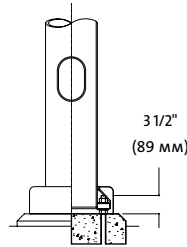

COMES WITH 4 ANCHOR BOLTS, 8 NUTS AND WASHERS.

**Specifications:**

**Pole:** Single-piece shaft, tapering using a cold-working process from seamless extruded aluminum (6063 wrought alloy) tubing. Free of longitudinal welds, its diameter and wall thickness are sufficient to withstand specified design loads. After tapering and welding, the entire shaft assembly is heat treated to T6 temper.

A 4 1/4" x 10 1/2" (108 mm x 267 mm) maintenance opening, complete with cover and ground lug, is centered 20" (508 mm) from the bottom of the anchor plate.

**Base cover:** made from two pieces of formed aluminum mechanically fastened to the base with stainless steel screws.

**Finish:** "Hot Dip" chemical etching preparation. Polyester powder coat textured finish. Available in a range of many RAL colors. Durable UV-resistant exterior finish as per # ASTM G7 and outstanding salt-spray resistance according to # ASTM B117 testing procedures.

**Options:**

**PH7:** Button-type photoelectric cell (specify operating voltage)

**DR:** Duplex receptacle (120V line volt only)

**GFI:** DR with common ground fault interrupter (120V line voltage only)

**Note:** EPA recommendations are calculated according to AASHTO standards and include a 30% gust factor, with a 50 lbs (23 kg) load applied at 1 ft. (305 mm) above the top of the pole. The maximum EPA rating shown is 30.0 sq. ft. Some poles may exceed this rating.

CATALOG NUMBER	POLE HEIGHT		WALL THICKNESS		WEIGHT		EPA RATING	EPA RATING	EPA RATING	EPA RATING	POLE BASE SIZE		POLE TOP SIZE		BASE SIZE		ANCHOR BOLTS	
	ft	m	in	mm	lbs	kg	70 mph	80 mph	87.5 mph	100 mph	in	mm	in	mm	in	mm	in	mm
ATRTN	8	2.44	0.188	4.8	82	37	30.0	30.0	30.0	30.0	8	203	6.375	162	12	305	1-36	25-914
ATRTN	10	3.05	0.188	4.8	92	42	30.0	30.0	30.0	30.0	8	203	6.375	162	12	305	1-36	25-914
ATRTN	12	3.66	0.188	4.8	102	46	30.0	30.0	30.0	29.1	8	203	6.375	162	12	305	1-36	25-914
ATRTN	14	4.27	0.188	4.8	112	51	30.0	30.0	25.9	20.1	8	203	6.375	162	12	305	1-36	25-914
ATRTN	16	4.88	0.188	4.8	122	55	30.0	26.3	22.2	17.2	8	203	6.375	162	12	305	1-36	25-914
ATRTN	18	5.49	0.188	4.8	132	60	29.2	22.6	19.1	14.5	8	203	6.375	162	12	305	1-36	25-914

# STRT

## STEEL TAPERED POLE ROUND

STRT

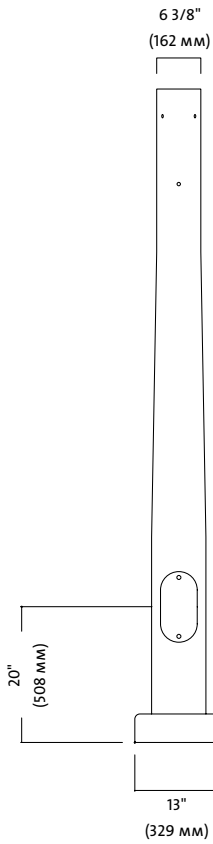

**BASE DETAILS:**

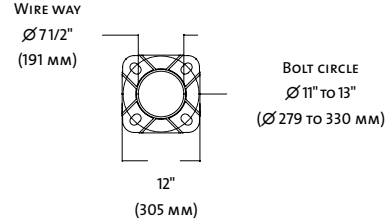
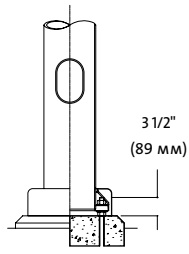

COMES WITH 4 ANCHOR BOLTS, 8 NUTS AND WASHERS.

**Specifications:**

**Pole:** Made from a mandrel-formed steel tapered round shaft having 6 3/8" (162 mm) at the top with 0.14 inch/feet welded to both the top and bottom of a steel base.

A 4 1/4" X 10 1/2" (108 mm x 267 mm) maintenance opening, complete with cover and ground lug, is centered 20" (508 mm) from the bottom of the anchor plate.

**Base cover:** Two pieces square base cover made from formed steel mechanically fastened with stainless steel screws.

**Finish:** "Hot Dip" chemical etching preparation. Polyester powder coat textured finish. Available in a range of many RAL colors. Durable UV-resistant exterior finish as per # ASTM G7 and outstanding salt-spray resistance according to # ASTM B117 testing procedures.

**Options:**

**PH7:** Button-type photoelectric cell (specify operating voltage)

**DR:** Duplex receptacle (120V line volt only)

**GFI:** DR with common ground fault interrupter (120V line voltage only)

**Note:** EPA recommendations are calculated according to AASHTO standards and include a 30% gust factor, with a 50 lbs (23 kg) load applied at 1 ft. (305 mm) above the top of the pole. The maximum EPA rating shown is 30.0 sq. ft. Some poles may exceed this rating.

CATALOG NUMBER	POLE HEIGHT		WALL THICKNESS		WEIGHT		EPA RATING	EPA RATING	EPA RATING	EPA RATING	POLE BASE SIZE		POLE TOP SIZE		BASE SIZE		ANCHOR BOLTS	
	ft	m	in	mm	lbs	kg	70 mph	80 mph	87.5 mph	100 mph	in	mm	in	mm	in	mm	in	mm
STRTD	8	2.44	0.120	3.0	136	62	30.0	30.0	30.0	30.0	7.49	190	6.375	162	12	305	1-36	25-914
STRTD	10	3.05	0.120	3.0	154	70	30.0	30.0	30.0	30.0	7.77	197	6.375	162	12	305	1-36	25-914
STRTD	12	3.66	0.120	3.0	176	80	30.0	30.0	30.0	30.0	8.05	204	6.375	162	12	305	1-36	25-914
STRTD	14	4.27	0.120	3.0	198	90	30.0	30.0	30.0	30.0	8.33	212	6.375	162	12	305	1-36	25-914
STRTD	16	4.88	0.120	3.0	220	100	30.0	30.0	30.0	30.0	8.61	219	6.375	162	12	305	1-36	25-914
STRTD	18	5.49	0.120	3.0	242	110	30.0	30.0	30.0	27.7	8.89	226	6.375	162	12	305	1-36	25-914

**Note:** Schröder reserves the right to substitute materials or change the manufacturing process of its products without prior notification.